

N7016A Type-C Low Speed Signal Access and Control Fixture

Quick Start and Accessories Guide



Low Speed Fixture
(N7016A)



USB Cable
(8121-1242)



Power Supply Plug Connector
(0360-2693)



Replacement Fuses (Qty. 4)
(2110-0623)

N7016A Type-C Low Speed Signal Access and Control Fixture

N7015A (sold separately)

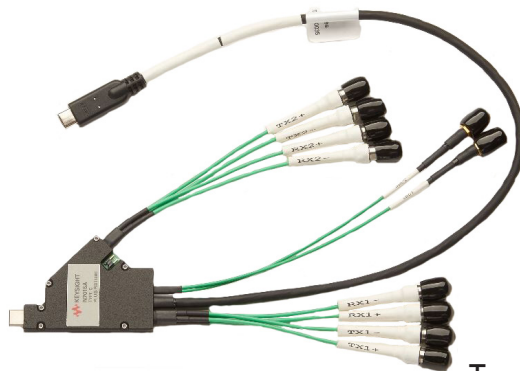

Type-C High Speed Plug Test Fixture



Wrench
(8710-2803)

N7017A (sold separately)



Type-C Receptacle Adapter
(N7017A)

This adapter can also be ordered with the N7015A test kit as the N7015A-017 option.

SETTING UP THE N7015A/16A TYPE-C TEST KIT

Pre-requisites:

- Download the Keysight N7015A Type-C High Speed Plug Test Fixture User Guide from www.keysight.com/find/N7015A.
- Download and install the *Keysight N7015A/6A USB Type-C Interconnect Assembly* software from www.keysight.com/find/N7015A.

Connection Steps:

Power on the N7016A fixture by connecting it to the Infiniium oscilloscope using the supplied USB cable

Connect the 2.92 mm connectors of the N7015A fixture to channel 1 and 3 of the Infiniium oscilloscope using the supplied wrench and an 8"-lb torque wrench (8710-1765) to prevent twisting of the cables.

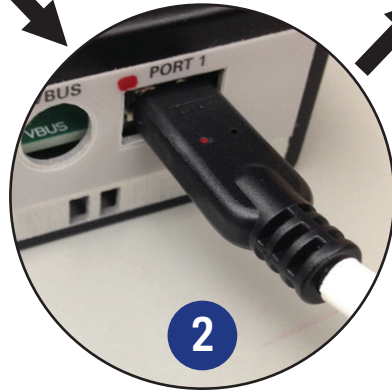

Connect the Type-C connector cable on the N7015A fixture to the port 1 of the N7016A fixture

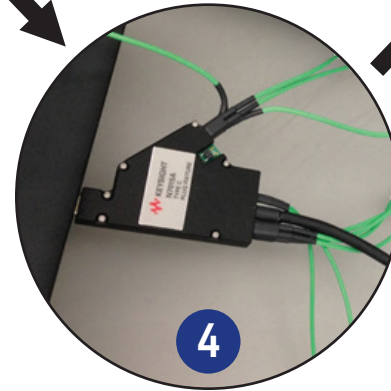
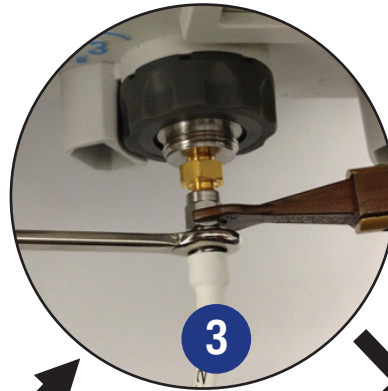

Connect the N7015A fixture to the Device Under Test

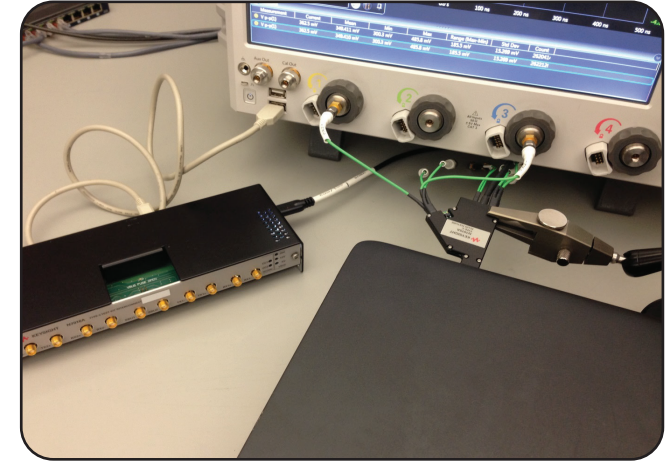

CAUTION

Minimize twisting of the N7015A cables while connecting these to the oscilloscope or the N7016A fixture